



## INSTALLATION INSTRUCTIONS KAWASAKI SOLO SEAT Model Fit: Vulcan VN900 models (Classic 2006-2009, Custom 2007-2009)

### ⚠ WARNING

Please read and understand these instructions completely before installation to avoid possible injury to yourself, or damage to the accessory or vehicle.

### CAUTION:

- Refer to the model's service manual for proper installation or adjustment.  
Be sure to have the service manual on hand, if necessary, before proceeding with the installation.

### LIMITED WARRANTY INFORMATION:

- Willie & Max warrants to the original retail purchaser that for a period of one year from the date of retail purchase, they will repair or replace, at their option, any product which is defective in material or quality.

#### 1. PARTS LIST:

This kit contains the following components. Before beginning installation, confirm there are no missing or damaged components. NOTE: This kit requires the use of your OEM mounting brackets.

Item #	Part Number	Description	Qty
1	59573-00	Solo Rider Seat	1
2	OEM PART	Mounting Bracket (OEM)	0
3	OEM PART	Washer (OEM)	0
4	OEM PART	Nut M6 x 1.0 (OEM)	0
5	13998-00	Washer, .38IDX.80ODX.10THK	6

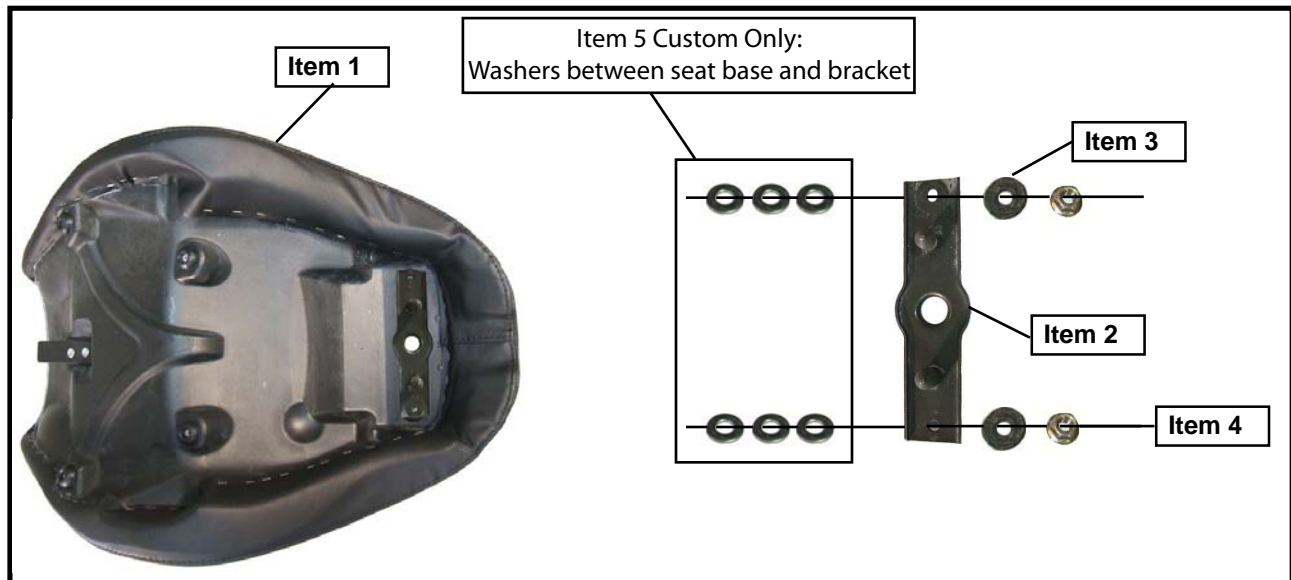

#### 2. Preparation:

- Place motorcycle on a secure stand.
- Clean all mounting surfaces before beginning installation.
- Remove rider seat as described in Owner's Manual.

#### 3. Installation:

- Install new seat in same manner as stock seat. Be sure seat tabs lock completely into stock mounting locations.

#### 4. Maintenance:

- Periodically check all hardware for tightness and re-torque as required. **DO NOT USE ALCOHOL BASED CLEANERS.**

#### 5. Care and Cleaning:

- Wash using a mild soap water solution and soft cloth. Clean with Saddle Soap.

#### 6. Customer Service:

- If you are having any problems with your Willie & Max product, please contact us by email at [custserv@willieandmax.com](mailto:custserv@willieandmax.com) or visit our website [www.willieandmax.com](http://www.willieandmax.com).